

For each panel installed, you will need (4) #8 1½" long stainless steel screws and screw covers (sold separately in matching colors).

- 1** In each corner there is an indentation showing the recommended fastener location. Using a ¼" drill bit to allow for expansion and contraction, pre-drill a hole in the center of each indentation (Fig. 1).

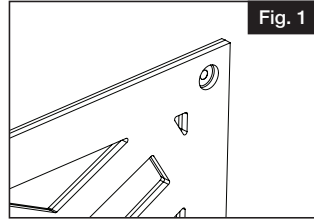

- 2** Place the panel in the desired location, mark the four corners on the mounting surface, and pre-drill using a ⅜" bit (Fig. 2).  
**NOTE:**

Be sure to allow an ⅛" between sheets for expansion and contraction.

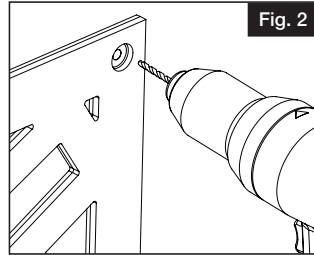

- 3** Place the screw cover over the screw shank. Line the screw up with the pre-drilled holes and secure the sheeting in place. Do not over-tighten the screw. Snap screw cover in place to hide the fastener (Fig. 3).

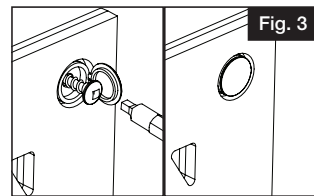

When cutting panel to smaller size:

- Use a carbide blade with no less than 24, but no more than 60 teeth; thin kerf
- Scrape away any plastic that built up along the edge with metal edge (e.g. a paint scraper or knife edge)
- Sand away any fibers that are left at edge if cut is still perceived as undesirable (100-200 grit paper recommended)

**NOTE:** All 4 corners of the panel must be fastened to the mounting surface